

# Total Suspended Solid System



## Features & Benefits

Potence Controls PCTSS1000A is a high-cost performance model with separate Transmitter and Sensor. It uses a method of Attenuation light as the measuring principle of the world common standard. The built-in wiper cleaning system keeps lenses clean. The optical windows are made of hard to scratch sapphire glass. The compact design makes it possible to install easily. Applications include measuring the TSS of the effluent from the waste water treatment plant makes it possible to monitor the treatment condition. Measurement of intake water for drinking water manufacturing process makes it possible to prevent any troubles that may be caused by sudden turbidity change.

- Attenuation light method
- Built-in wiper cleaning system
- Sapphire glass of the optical windows
- Compact design

## Sensor Specifications

Measuring Range	: 0 - 1000 (mg/L)
Cleaning System	: Both Sided swing wiper cleaning system
Time Interval for cleaning	: Clean once immediately after power-on and subsequently clean once every 10 minutes
Operating Temperature	: 0 - 50°C
MOC	: SS 316L, Sapphire Glass, Fluorocarbon Rubber, EPDM, POM
Dimensions	: $\Phi$ 32 x 170mm
Weight	: Approx. 930g
Degree of Protection	: IP68
Sensor Cable Length	: 10m

## Controller Specifications

Measuring Range	: 0 - 1000 (mg/L)
Power Supply	: 100 - 240 VAC $\pm$ 10% 50/60Hz
Display Resolution	: 0.1mg/L (0-49.9 mg/L), 1mg/L (50 - 1000mg/L)
Output	: Analog 4 - 20mA, resistance load of 300 $\Omega$
Relay	: Self - Checking Relay (Potential free) Alarm Relay Output (Potential Free)
Operating Temperature	: 0 - 50°C
MOC	: Polycarbonate
Degree of Protection	: IP65
Linearity	: $\pm$ 10% of R.S. or $\pm$ 30 mg/L (whichever is greater)
Accuracy	: $\pm$ 3% of R.S. or $\pm$ 30 mg/L (whichever is greater)
Repeatability	: $\pm$ 3% of R.S. or $\pm$ 30 mg/L (whichever is greater)
Response Time	: Approx. 10s to respond 90% of concentration
Dimensions	: H x W x D approx. (162 x 240 x 75 mm)
Weight	: Approx. 1.6kg

# Dimensional Drawing

Sensor

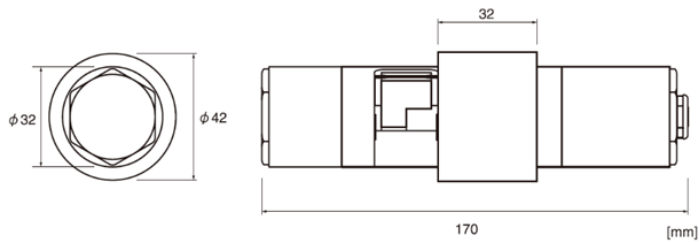

Controller

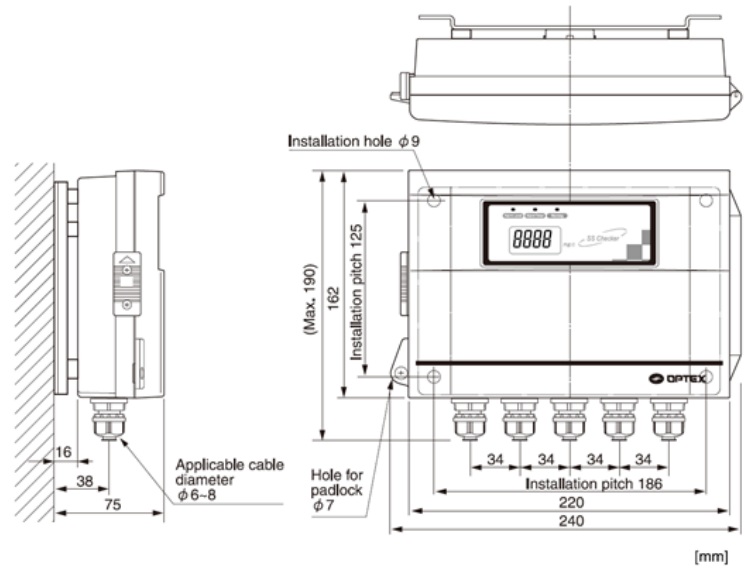

# Ordering Information

**Model Number:**

PCTSS1000A : TSS Sensor, Range: 0 - 1000mg/L (works with PC211A)

PC211A : Single Channel TSS Controller, 100 - 240 VAC Input Power, 4 - 20mA, 2 Relays

In the interest of improving and updating, PCPL reserves the right to alter specifications at any time.